

10K (KS B1503 / JIS B2220)

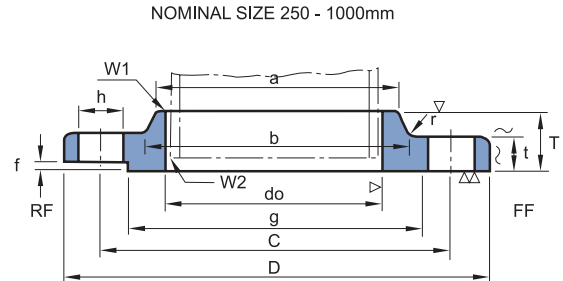
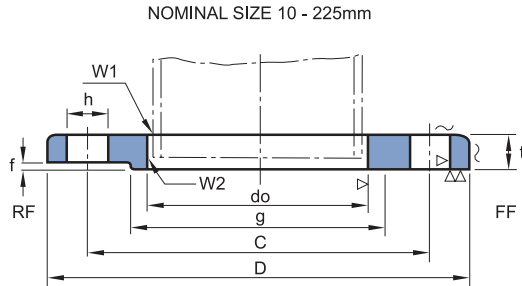

Unit : mm

Nominal Dia. of Flange	Outside Dia. of Flange D	Sectional Dimensions of flange												Nominal Bolt Size	Welding	
		Dia. of Bolt Circle C	Dia. of Raised Face g	Inside Dia. of Flange do	Outside Dia. of Appil-Cable pipe	t	T	Dia. of Hub		Radi-us r	Raised Face f	Hole Dia. h	Number of Bolt Holes		W1	W2
								a	b							
10	90	65	46	17.8	17.3	12	-	-	-	-	1	15	4	M12	5	2.5
15	95	70	51	22.2	21.7	12	-	-	-	-	1	15	4	M12	5	3
20	100	75	56	27.7	27.2	14	-	-	-	-	1	15	4	M12	5	3
25	125	90	67	34.5	34	14	-	-	-	-	1	19	4	M16	5	3
32	135	100	76	43.2	42.7	16	-	-	-	-	2	19	4	M16	6	3
40	140	105	81	49.1	48.6	16	-	-	-	-	2	19	4	M16	6	3
50	155	120	96	61.1	60.5	16	-	-	-	-	2	19	4	M16	6	3
65	175	140	116	77.1	76.3	18	-	-	-	-	2	19	4	M16	6.5	4
80	185	150	126	90	89.1	18	-	-	-	-	2	19	8	M16	6.5	4
(90)	195	160	136	102.6	101.6	18	-	-	-	-	2	19	8	M16	6.5	4
100	210	175	151	115.4	114.3	18	-	-	-	-	2	19	8	M16	7	4
125	250	210	182	141.2	139.8	20	-	-	-	-	2	23	8	M20	7.5	4
150	280	240	212	166.6	165.2	22	-	-	-	-	2	23	8	M20	8	5
(175)	305	265	237	192.1	190.7	22	-	-	-	-	2	23	12	M20	9	5
200	330	290	262	218	216.3	22	-	-	-	-	2	23	12	M20	9	6
(255)	350	310	282	243.7	241.8	22	-	-	-	-	2	23	12	M20	9	6
250	400	355	324	269.5	267.4	24	36	288	292	6	2	25	12	M22	10	6
300	445	400	368	321	318.5	24	38	340	346	6	3	25	16	M22	10	6
350	490	445	413	358.1	355.6	26	42	380	386	6	3	25	16	M22	12	7
400	560	510	475	409	406.4	28	44	436	442	6	3	27	16	M24	12	7
450	620	565	530	460	457.2	30	48	496	502	6	3	27	20	M24	14	8
500	675	620	585	511	508	30	48	548	554	6	3	27	20	M24	14	8
550	745	680	640	562	558.8	32	52	604	610	6	3	33	20	M30	15	9
600	795	730	690	613	609.6	32	52	656	662	6	3	33	24	M30	16	10
650	845	780	740	664	660.4	34	56	706	712	6	3	33	24	M30	16	10
700	905	840	800	715	711.2	34	58	762	770	6	3	33	24	M30	17	10
750	970	900	855	766	762	36	62	816	824	6	3	33	24	M30	18	11
800	1020	950	905	817	812.8	36	64	868	876	6	3	33	28	M30	19	12
(850)	1070	1000	955	868	863.6	36	66	920	928	6	3	33	28	M30	19	12
900	1120	1050	1005	919	914.4	38	70	971	979	6	3	33	28	M30	22	14
1000	1235	1160	1110	1021	1016	40	74	1073	1081	6	3	39	28	M36	22	14
*(1100)	1345	1270	1220	1123	1117.6	42	-	-	-	-	3	39	28	M36		
*1200	1465	1380	1325	1225	1219.2	44	-	-	-	-	3	39	32	M36		
*1350	1630	1540	1480	-	1371.6	48	-	-	-	-	3	45	36	M42		
*1500	1795	1700	1635	-	1524.0	50	-	-	-	-	3	45	40	M42		

NOTE:

1. Flanges of parenthesized nominal diameter (), not to be used unless otherwise noted by purchaser.
2. The facing of flanges shall conform to KS B1519 (JIS B2202)
3. Nominal diameter over 1000 is manufacturer's standard (*)