

5K (KS B1503 / JIS B2220)

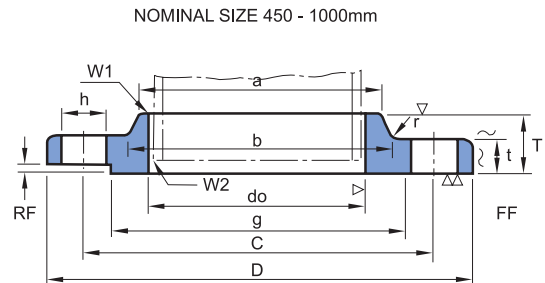
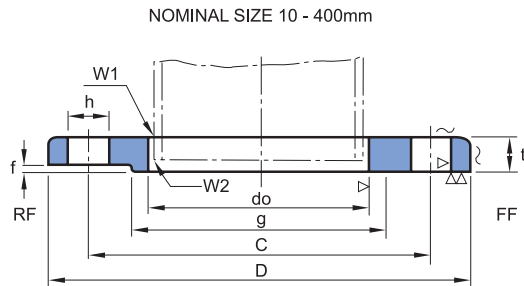

Unit : mm

Nominal Dia. of Flange	Outside Dia. of Flange D	Sectional Dimensions of flange												Nominal Bolt Size	Welding	
		Dia. of Bolt Circle C	Dia. of Raised Face g	Inside Dia. of Flange do	Outside Dia. of Applicable pipe	t	T	Dia. of Hub		Radi-us r	Raised Face f	Hole Dia. h	Number of Bolt Holes		W1	W2
								a	b							
(10)	75	55	39	17.8	17.3	9	-	-	-	-	1	12	4	M10	5.0	2.5
15	80	60	44	22.2	21.7	9	-	-	-	-	1	12	4	M10	5.0	3.0
(20)	85	65	49	27.7	27.2	10	-	-	-	-	1	12	4	M10	5.0	3.0
25	95	75	59	34.5	34.0	10	-	-	-	-	1	12	4	M10	5.0	3.0
(32)	115	90	70	43.2	42.7	12	-	-	-	-	2	15	4	M12	6.0	3.0
40	120	95	75	49.1	48.6	12	-	-	-	-	2	15	4	M12	6.0	3.0
50	130	105	85	61.1	60.5	14	-	-	-	-	2	15	4	M12	6.0	3.0
65	155	130	110	77.1	76.3	14	-	-	-	-	2	15	4	M12	6.0	4.0
80	180	145	121	90.0	89.1	14	-	-	-	-	2	19	4	M16	6.0	4.0
(90)	190	155	131	102.6	101.6	14	-	-	-	-	2	19	4	M16	6.0	4.0
100	200	165	141	115.4	114.3	16	-	-	-	-	2	19	8	M16	7.0	4.0
125	235	200	176	141.2	139.8	16	-	-	-	-	2	19	8	M16	7.0	4.0
150	265	230	206	166.6	165.2	18	-	-	-	-	2	19	8	M16	7.0	5.0
(175)	300	260	232	192.1	190.7	18	-	-	-	-	2	23	8	M20	7.5	5.0
200	320	280	252	218.0	216.3	20	-	-	-	-	2	23	8	M20	8.5	6.0
(225)	345	305	277	243.7	241.8	20	-	-	-	-	2	23	12	M20	9.0	6.0
250	385	345	317	269.5	267.4	22	-	-	-	-	2	23	12	M20	10.0	6.0
300	430	390	360	321.0	318.5	22	-	-	-	-	3	23	12	M20	10.0	6.0
350	480	435	403	358.1	355.6	24	-	-	-	-	3	25	12	M22	12.0	7.0
400	540	495	463	409.0	406.4	24	-	-	-	-	3	25	16	M22	12.0	7.0
450	605	555	523	460.0	457.2	24	40	495	500	5	3	25	16	M22	12.0	7.0
500	655	605	573	511.0	508.0	24	40	546	552	5	3	25	20	M22	12.0	7.0
550	720	665	630	562.0	558.8	26	42	597	603	5	3	27	20	M24	12.0	7.0
600	770	715	680	613.0	609.6	26	44	648	654	5	3	27	20	M24	12.0	7.0
650	825	770	735	664.0	660.4	26	48	702	708	5	3	27	24	M24	12.0	7.0
700	875	820	785	715.0	711.2	26	48	751	758	5	3	27	24	M24	12.0	7.0
750	945	880	840	766.0	762.0	28	52	802	810	5	3	33	24	M30	12.0	7.0
800	995	930	890	817.0	812.8	28	52	854	862	5	3	33	24	M30	13.0	8.0
850	1045	980	940	868.0	863.6	28	54	904	912	5	3	33	24	M30	13.0	8.0
900	1095	1030	990	919.0	914.4	30	56	956	964	5	3	33	24	M30	13.0	8.0
1000	1195	1130	1090	1021.0	1016.0	32	60	1058	1066	5	3	33	28	M30	14.0	9.0
*(1100)	1305	1240	1200	1123.0	1117.6	32	-	-	-	-	3	33	28	M30		
*1200	1420	1350	1305	1225.0	1219.2	34	-	-	-	-	3	33	32	M30		
*1350	1575	1505	1460	-	1371.6	34	-	-	-	-	3	33	32	M30		
*1500	1730	1660	1615	-	1524.0	36	-	-	-	-	3	33	36	M30		

NOTE:

- Flanges of parenthesized nominal diameter () , not to be used unless otherwise noted by purchaser.
- The facing of flanges shall conform to KS B1519 (JIS B2202)
- Nominal diameter over 1000 is manufacturer's standard (*)